

## **ACCESSORY MANUAL**

English

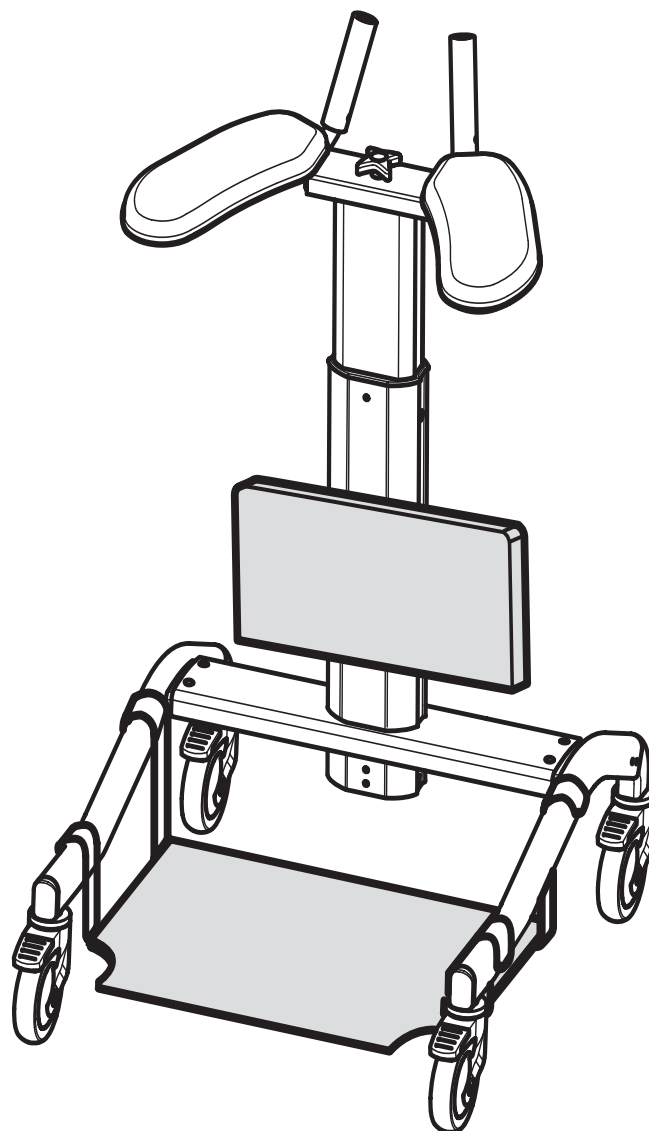

## **STAND ASSIST**



The manual for the “Stand Assist” accessory is a supplement to the main manual for **DOLomite STEP UP** and must always be used together with the user manual with part no. 1532567.



# Intended use

**DOLOMITE STAND ASSIST** is an aid for users who need support to stand. *STAND ASSIST* consists of a standing plate, knee support and a support harness.

...can also be used as a transfer aid.

...should be used together with **DOLOMITE STEP UP** walking table.

...can be used as uprising help on *STEP UP* electrical.

...can be used on *STEP UP* hydraulic, manual and electrical.

...is meant for indoor use.

...can not be used in wet environments.

## Assembly

### 1. Standing plate

Fasten the standing plate to the frame by passing the stop wire under the crossbar and hanging the attachments over the arms of the frame.

NB! Check that the standing plate is securely in position.



When mounting the standing plate, be careful for pinching risk between the attachment of the standing plate and the frame.

### 2. Knee guard

A) Fasten the knee support by placing the locking plate in the slot on the centre pillar, then turn the plate to the correct position (see illustration).

B) Mount the holder for the knee support to the plate and tighten the knob. The notches should be turned upwards.



Be extra careful not to place the attachment for the knee support over the emergency stop button (A). The attachment must be placed either above, or below the emergency stop button.

C) Untighten the knobs on the knee support, but do not remove them. Slip the knee support onto the holder and tighten the knobs carefully (see illustration).

### 3. Mount / loosen the harness

Secure the harness to the walking table by passing the fastening loops of the harness over the handles (A). You loosen the harness by opening the snap attachment (B) or by lifting one or both of the fastening loops from the handles.

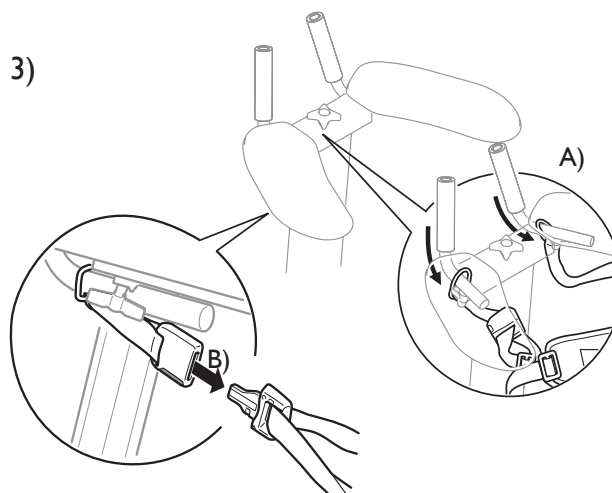
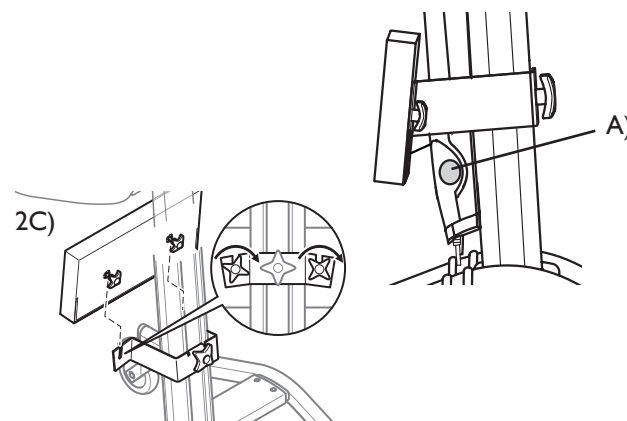
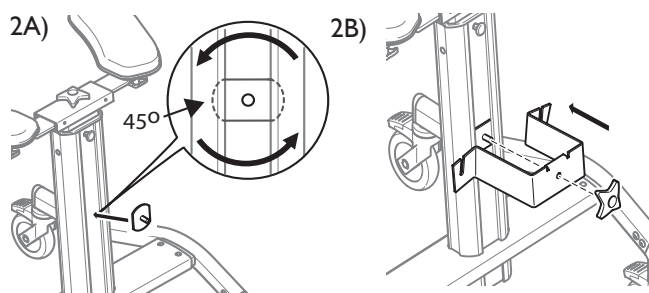
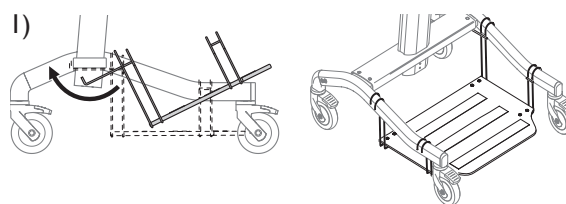

# Ergonomics/Adjustment

## 4. Adjust the harness

The length of the harness can be adjusted by loosening the attachment (A). The length can also be adjusted by choosing either the inner (B), or the outer (B) loop when mounting the harness.



Make sure that the user is supported before undoing the harness or opening the fastener for the harness!

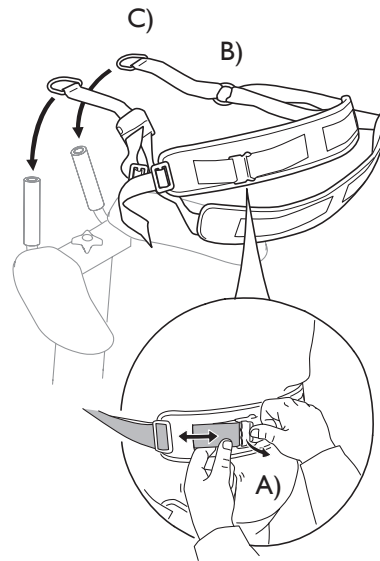

## 5. Adaptions for the user

- Place the wheels forward to make the support surface as large as possible.
- Lock the parking brakes of the walking table.
- The user must stand as close as possible to the front of the standing plate.
- Adjust the knee support, it should be placed under the knees of the user in order to decrease the stress on the knees.
- Help the user to an uprised position if needed.
- Mount the harness when the user is standing, the harness should be placed as shown on the picture.
- The stress-relievers on the strap should be placed behind the back, and under the bottom (A) in order to give the most support.
- Adjust the strap to a suitable length before the user is in an uprised position.
- The strap with the attachment should be placed on the back of the user in order for an easy access to the adjustment.
- Fineadjust the strap (B) when the user is in an uprised position to get the most optimal support from the harness.
- Make sure that the user is secured during the time when the harness is adjusted. To enhance the feeling of security for the user, place a hand against the back.

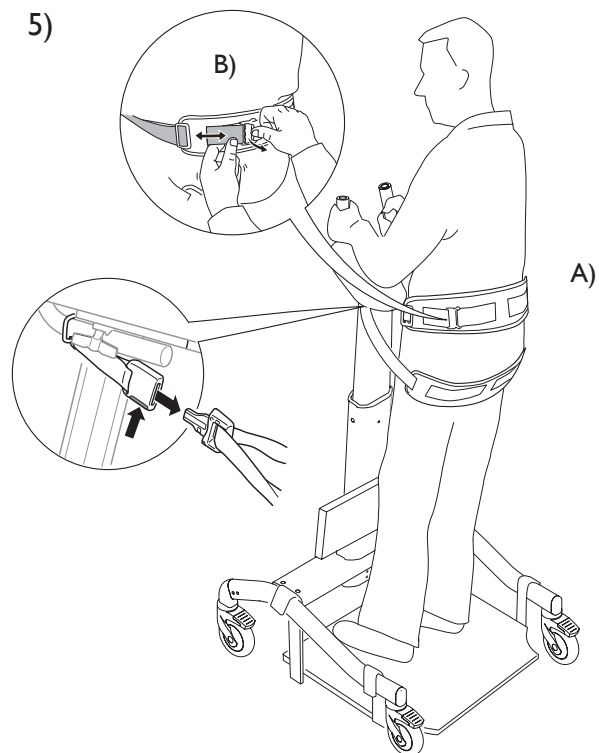

## 6. Transfer of the user

- The user can be transferred standing on the standing plate a shorter distance indoors.
- Undo the parking brakes, transfer the user and lock the parking brakes again.

 Be careful when transferring the user on uneven surfaces.

 Be careful when transferring the user over obstacles, e.g doorways.

The harness must always be mounted when the user is transferred on the standing plate.

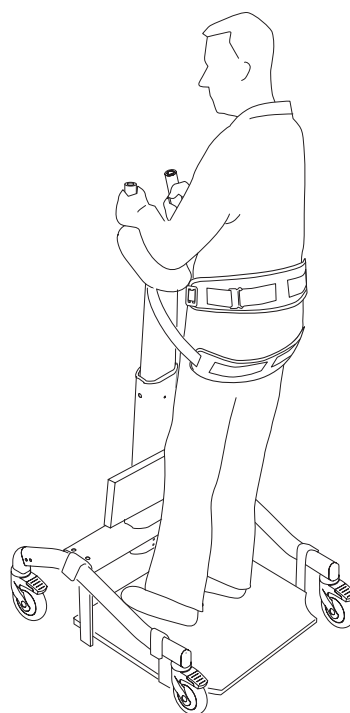

## 7. Uprising help

When using the product as an uprising help, the users physical abilities must be taken into consideration. The user must have some strength in the arms and legs in order to be able to use the function.

**DOLOMITE STAND ASSIST** should only be used as an uprising help in combination with **DOLOMITE STEP UP** electrical.

Always consult with medical expertise before using **DOLOMITE STEP UP** in combination with Stand Assist as an uprising help.

- Place the wheels forward to make the support surface as large as possible.
- Place the arm support in a low position with help of the hand control.
- The user must place the feet as close as possible to the front of the standing plate, lean forward and hold the push handles while the assistant adjusts the height of the arm supports upwards with the hand control.
- The user must at the same time have the strength to use the legs and arms to push/pull themselves up to a standing position.

For further information - see chapter 5 "Adaptions for the user".

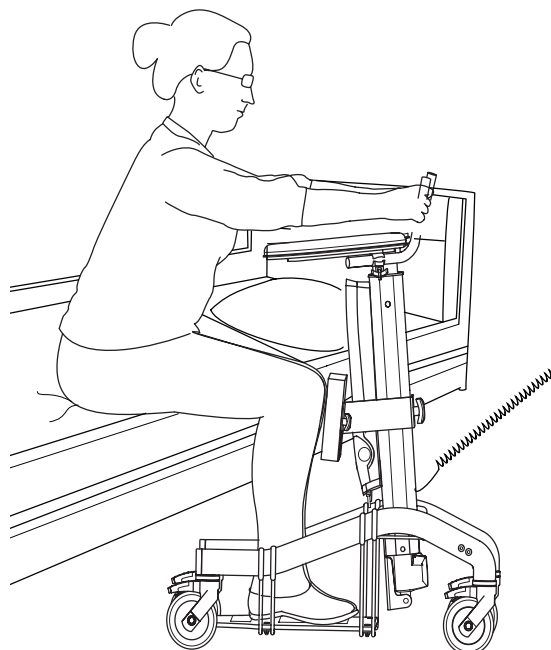

# Safety



**DOLOMITE STAND ASSIST** must always be used with the safety harness provided. The harness should always be mounted when the user is standing. The user can only stand up without the harness if medical expertise have certified that it is without risk for the user and if the user is not transferred on the standing plate.



**DOLOMITE STAND ASSIST** should not be used in areas where there is a risk that the product gets sprinkled with water. For example shower areas.



**DOLOMITE STAND ASSIST** must only be used when an assistant is present. Do not leave the user standing alone on the standing plate.



The wheels on the platform support must be locked except for when the user is transferred on the standing plate.



Be careful and make sure that the walking table does not overturn on the user when he/she rises/sits down.

INVACARE accepts no responsibility for work carried out on **DOLOMITE STAND ASSIST** (adjustments, faulty repairs), outside of **INVACARE**'s control.

## Maintenance and service

### Cleaning

- **DOLOMITE STAND ASSIST** can be wiped with a damp cloth, but is not suitable for cleaning in a washing machine or by high-pressure water cleaners.
- After cleaning, allow the product to dry fully.
- The removable cover for the knee support cushion and the harness for **DOLOMITE STAND ASSIST** can be cleaned with most common cleaning agents available on the market.
- Never use acids, bases or solvents to clean the product.

## **Notes**

## **Notes**

# Sales units

## Belgium & Luxemburg:

Invacare nv, Autobaan 22, B-8210 Loppem  
Tel: (32) (0)50 83 10 10, Fax: (32) (0)50 83 10 11  
belgium@invacare.com / <http://www.invacare.be>

## Danmark:

Invacare A/S, Sdr. Ringvej 37, DK-2605 Brøndby  
Tel: (45) (0)36 90 00 00, Fax: (45) (0)36 90 00 01  
denmark@invacare.com / <http://www.invacare.dk>

## Deutschland:

Invacare GmbH, Alemannenstraße 10, D-88316 Isny  
Tel: (49) (0)75 62 7 00 0, Fax: (49) (0)75 62 7 00 66  
info@invacare-aquatec.com / <http://www.invacare-aquatec.de>

Ulrich Alber GmbH, Vor dem Weissen Stein 21, D-72461  
Albstadt-Tailfingen  
Tel: (49) (0)7432 2006 0, Fax: (49) (0)7432 2006 299  
info@ulrich-alber.de

## European Distributor Organisation:

Invacare, Kleiststraße 49, D-32457 Porta Westfalica  
Tel: (49) (0)57 31 754 540, Fax: (49) (0)57 31 754 541  
edo@invacare.com / <http://www.invacare.eu.com>

## España:

Invacare SA, c/Areny s/n, Polígon Industrial de Celrà,  
E-17460 Celrà (Girona)  
Tel: (34) (0)972 49 32 00, Fax: (34) (0)972 49 32 20  
contactsp@invacare.com / <http://www.invacare.es>

## France:

Invacare Poirier SAS, Route de St Roch, F-37230 Fon-  
dettes  
Tel: (33) (0)2 47 62 64 66, Fax: (33) (0)2 47 42 12 24  
contactfr@invacare.com / <http://www.invacare.fr>

## Ireland:

Invacare Ireland Ltd, Unit 5 Seatown Business Campus,  
Seatown Road, Swords, County Dublin - Ireland  
Tel: (353) 1 810 7084, Fax: (353) 1 810 7085  
ireland@invacare.com / <http://www.invacare.ie>

## Italia:

Invacare Mecc San s.r.l., Via dei Pini 62, I-36016 Thiene  
(VI)  
Tel: (39) 0445 38 00 59, Fax: (39) 0445 38 00 34  
italia@invacare.com / <http://www.invacare.it>

## Nederland:

Invacare BV, Celsiusstraat 46, NL-6716 BZ Ede  
Tel: (31) (0)318 695 757, Fax: (31) (0)318 695 758  
nederland@invacare.com / <http://www.invacare.nl>  
csede@invacare.com

## Norge:

Invacare AS, Grensesvingen 9, Postboks 6230, Etterstad,  
N-0603 Oslo  
Tel: (47) (0)22 57 95 00, Fax: (47) (0)22 57 95 01  
norway@invacare.com / <http://www.invacare.no>  
island@invacare.com

## Österreich:

Invacare Austria GmbH, Herzog Odilostrasse 101,  
A-5310 Mondsee  
Tel: (43) 6232 5535 0, Fax: (43) 6232 5535 4  
info@invacare-austria.com / <http://www.invacare.at>

## Portugal:

Invacare Lda, Rua Estrada Velha, 949, P-4465-784 Leça do  
Balio  
Tel: (351) (0)225 1059 46/47, Fax: (351) (0)225 1057 39  
portugal@invacare.com / <http://www.invacare.pt>

## Sverige & Suomi:

Invacare AB, Fagerstagatan 9, S-163 91 Spånga  
Tel: (46) (0)8 761 70 90, Fax: (46) (0)8 761 81 08  
sweden@invacare.com / <http://www.invacare.se>  
finland@invacare.com

## Switzerland:

Invacare AG, Benkenstrasse 260, CH-4108 Witterswil  
Tel: (41) (0)61 487 70 80, Fax: (41) (0)61 487 70 81  
switzerland@invacare.com / <http://www.invacare.ch>

## United Kingdom:

Invacare Limited, Pencoed Technology Park, Pencoed,  
Bridgend CF35 5AQ  
Switchboard Tel: (44) (0)1656 776200, Fax: (44) (0)1656  
776201  
Customer services Tel: (44) (0)1656 776222, Fax: (44)  
(0)1656 776220  
UK@invacare.com / <http://www.invacare.co.uk>



## Manufacturer

INVACARE DOLOMITE AB, Box 200, 343 75 DIÖ, SWEDEN  
TEL +46 (0)476 535 00, FAX +46 (0)476 535 99

